

4 DOORS 2 DRAWERS WARDROBE

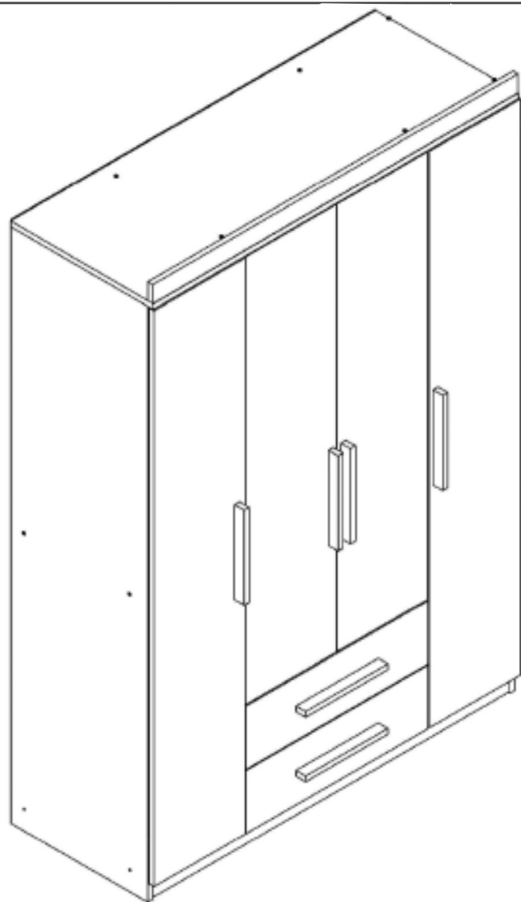

- | | | | |
|------------------------|--------------------------|-----------------------------|----------------------|
| SCREW 6.3*50
41 PCS | ALLYAN STOPPER
20 PCS | HANGER FALNGE
6 PCS | DRAWER RAIL
4 PCS |
| SCREW 3,5*18
76 PCS | MINIFIX MIL
4 PCS | OUTER COVER HINGE
6 PCS | |
| HANDLE SCREW
12 PCS | MINIFIX HEAD
4 PCS | MIDDLE COVER HINGE
6 PCS | SHELF PIN
5 PCS |
| ALLYAN
1 PCS | DOWEL
8 PCS | HANDLE
6 PCS | |
| NAIL
50 PCS | | | |



WHEN ATTACHING THE HINGES, MOUNT THE MIDDLE COVER HINGES TO THE MIDDLE COVERS, AND THE EXTERIOR COVER HINGES TO THE EXTERIOR COVERS.



STRICTLY INSTALL THE PRODUCT BY PLATING IT ON THE FLOOR.

PLEASE SEE THE BACK OF THE PAPER TO REVIEW THE INSTALLATION DIAGRAM.



1. STEP

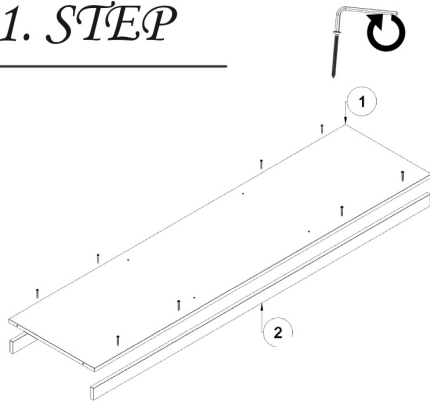

Let's fix the bottom plate number 1 to the bed base number 2 with the help of allen screw and allen.

2. STEP

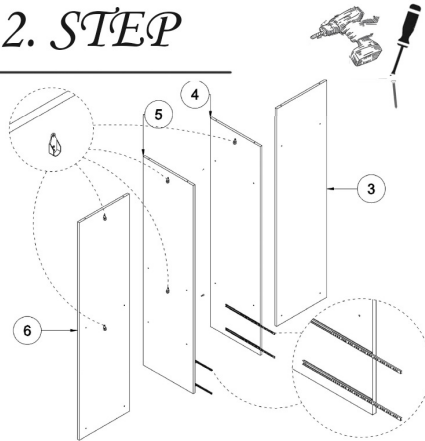

Screw the drawer rails to the doors 4 and 5 using a cordless or screwdriver.

3. STEP

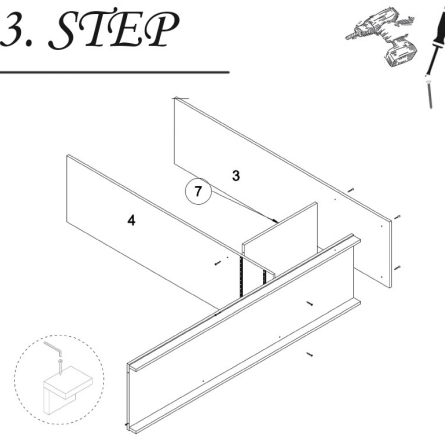

Assemble the side plate number 3, the fixed shelf number 7 and finally the middle pole number 4 on the bottom plate, respectively.

4. STEP

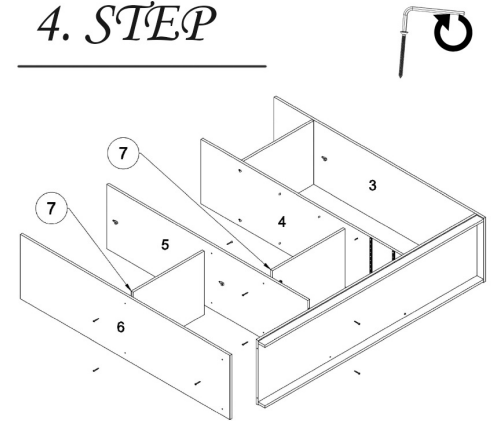

Assemble the fixed shelf number 7, the middle pillar number 5, the fixed shelf number 7 and the side plate number 6, with the logic in step 3.

5. STEP

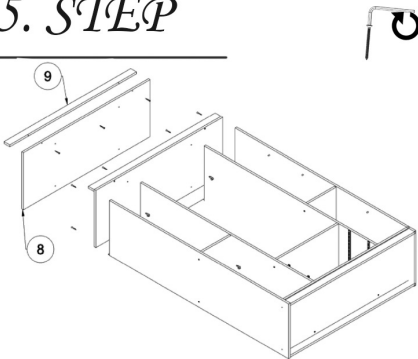

Mount the crown number 9 on the top plate 8, and then fix the top plate on the cabinet.

6. STEP

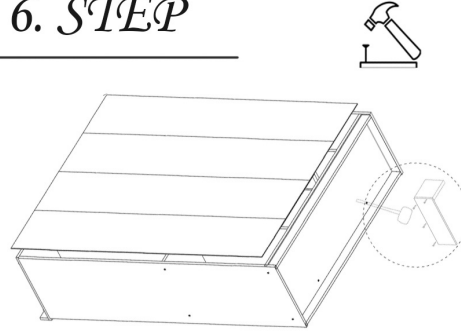

Turn the cabinet carefully to its back and hammer and nails the backs.

7. STEP

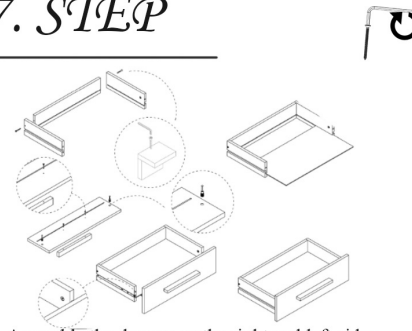

Assemble the drawer on the right and left sides, respectively, to the back of the drawer with cabinet screws. Then pass the backrest. Attach the handle to the front of the drawer with the screw. Then attach minifix shafts to the front of the drawer and mount them to the drawer frame.

8. STEP

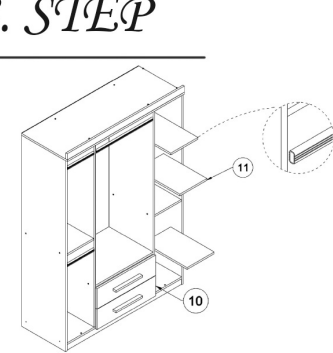

Let's raise the cabinet carefully, then put the pull, hanger flanges and mobile shelves.

9. STEP

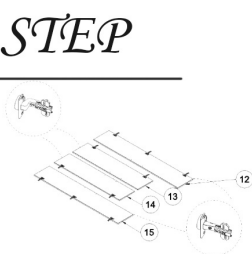

Mount the outer door hinges on the outer doors 12 and 15, then the middle door hinges on the middle doors 13 and 14.

10. STEP

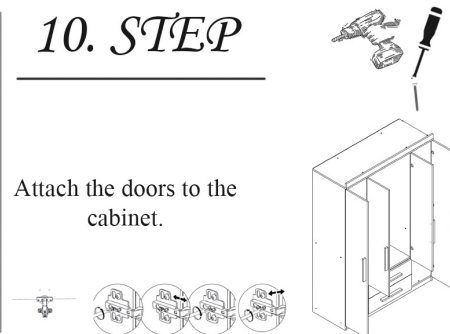

Attach the doors to the cabinet.

11. STEP

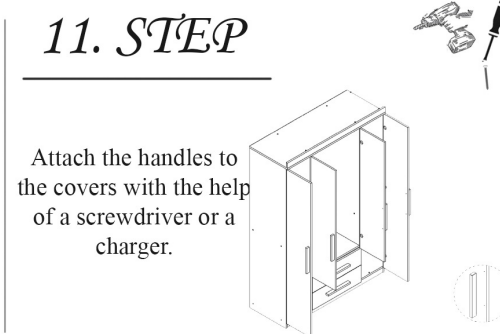

Attach the handles to the covers with the help of a screwdriver or a charger.

12. STEP

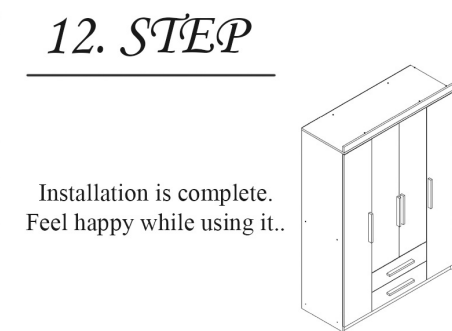

Installation is complete. Feel happy while using it..